



mario cotta
Zincometal Group

PPS

Replicability and *Objectivity*. These are the two drivers of **mario cotta** 's projects.

The **quality of the slitting process** is strictly related to the possibility to maintain the identical setting on every single Knife Holder on the slitting system. Excluding every **variable**, related to the **operator abilities** and to the **environment**, it's the only way to obtain the **perfect cut**.

PPS Pneumatic knife holder is the perfect match between User-Friendliness and Performance.

50mm Minimum Cut, **reduction of the Machine Downtime**, **High speed with high slitting quality**, maximum **safety for operators**. These are the achieved targets of PPS Pneumatic Knife Holder.

100% Proudly Made in Italy!

For major dimensions, please contact our office.

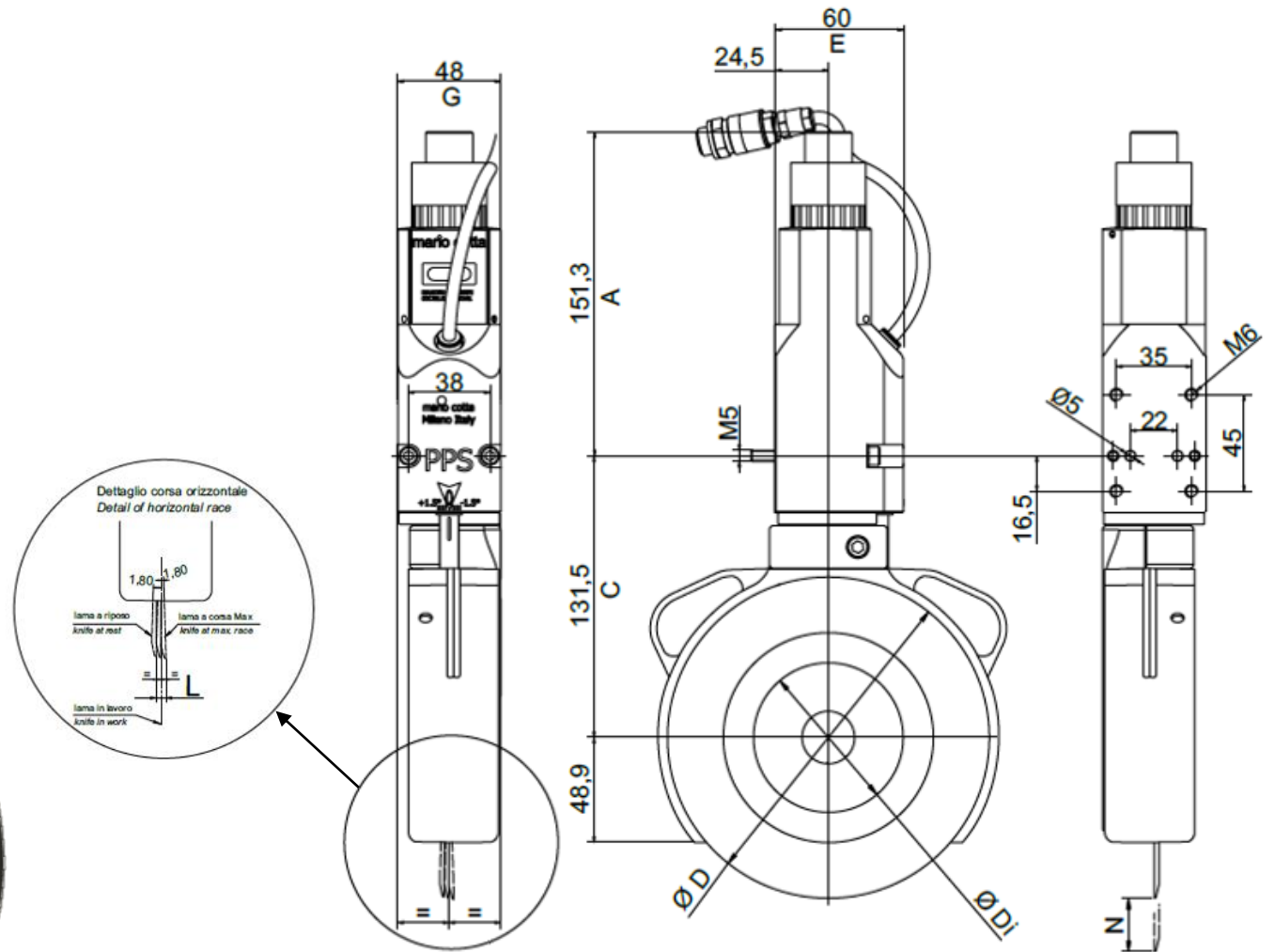

Single Air Inlet

Calibrated Nonius for Knife Diameter

Mechanical Half Approach

Cant Angle Regulation

Button for Knife's change

Tilting Side Approach



PPS Knife Holder

Graduated Nonius



The Nonius allows a **replicable** and **objective regulation** of the knife **penetration** in order to maintain the most **effective** overlap also after changing or regrinding knives.

Patented System

Cant Angle

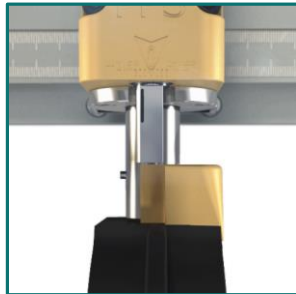

The special asymmetric shaft allows, through a simple operation to set the cant angle to $\pm 1,5^\circ$. Other angles are obtainable on demand.

Single Air Inlet



Decreased setup time thanks to the automatic Descent-Side Load / Side Unload-Ascent Cycle.

Button for Knife's change



The **Button**, located on the knife holder's backside, **locks the knife rotating flange**, thus facilitating knife quick change. This will **decrease setup times** and it will **increase operators' safety**.

Tilting Side Approach

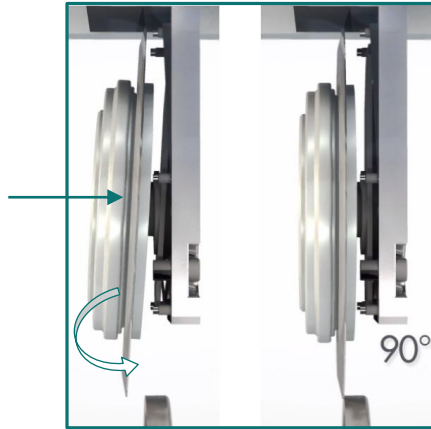

Tilting Side Approach allows to disengage the movement unit from rotation unit granting a drastic **reduction** of the **Run Out** and an **higher blades' average life**.

Furthermore, blade results always **centered** amongst knife holder, maintaining the minimum slitting width of **50mm** also **between left and right hands Knife Holders**.

[Patented System](#)

Mechanical Half Approach

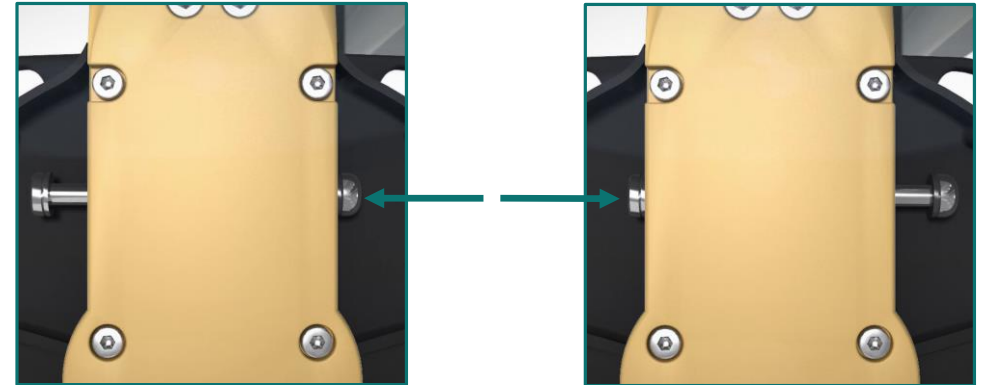

The **Mechanical Half Approach** could be activated through a piston located on the knife holder's backside. This piston, if engaged, **limits tilting movement**.

Half Approach allows a quick and effective Knife Holder setup that **avoids the knife overlap** onto bottom knife and a **constant side load**.



Characteristics & Optional

Characteristics

- ✓ 50mm Minimum slit width
- ✓ Vertical Stroke 25 mm
- ✓ Horizontal Stroke 3,5 mm
- ✓ Separated Bracket
 - ✓ Dove Tail
 - ✓ Dove Tail with Pinion
 - ✓ Linear with 1 ball-bearings carrier
 - ✓ Linear with 2 ball-bearings carriers

Optional

- ✓ Dust Suction Device
- ✓ Lubricator

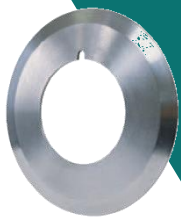

Standard Blades Compatibility

- 150x70-80 mm
- 130x70-80 mm



Shear Cut Capability

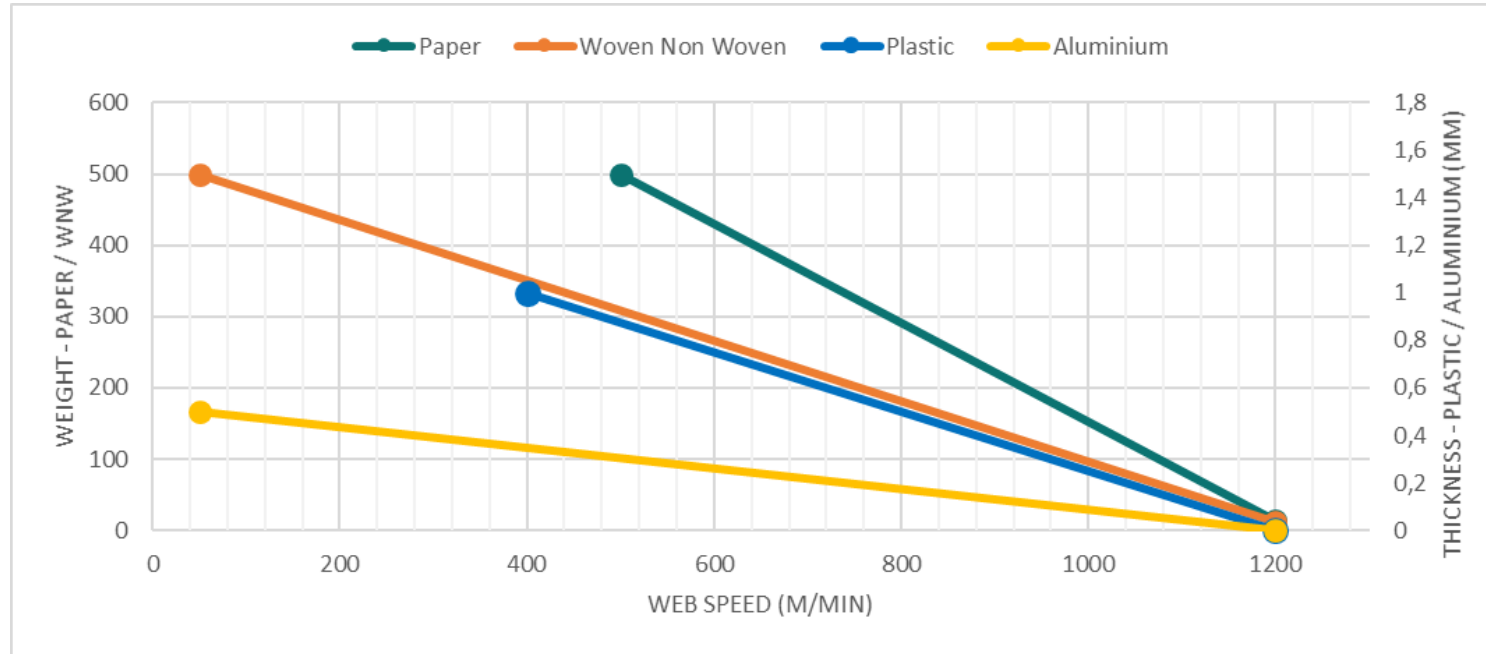

	Paper	Woven Non Woven	Flexible Plastic	Aluminium
Maximum Slitting Speed	Up to 1200 m/min with a slitting of 14 g/m ²	Up to 1200 m/min with a slitting of 11 g/m ²	Up to 1200 m/min with a slitting of 18 µm	Up to 1200 m/min with a slitting of 15 µm
Maximum Slitting Capability	Up to 500 g/m² with a speed of 500 m/min	Up to 500 g/m² with a speed of 50 m/min	Up to 1 mm with a speed of 400 m/min	Up to 0,5 mm with a speed of 50 m/min
Minimum Slitting Width	50 mm	50 mm	50 mm	50 mm



Slitting Capability – Load Graphs

Vertical Load

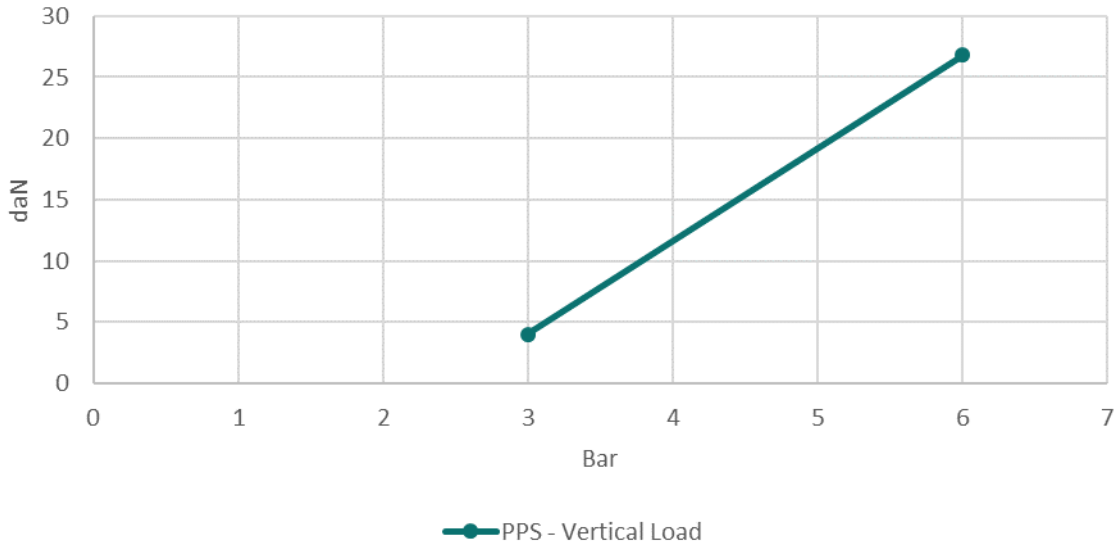

Vertical Load of 26,8 daN at 6 bar pressure.

Side Load

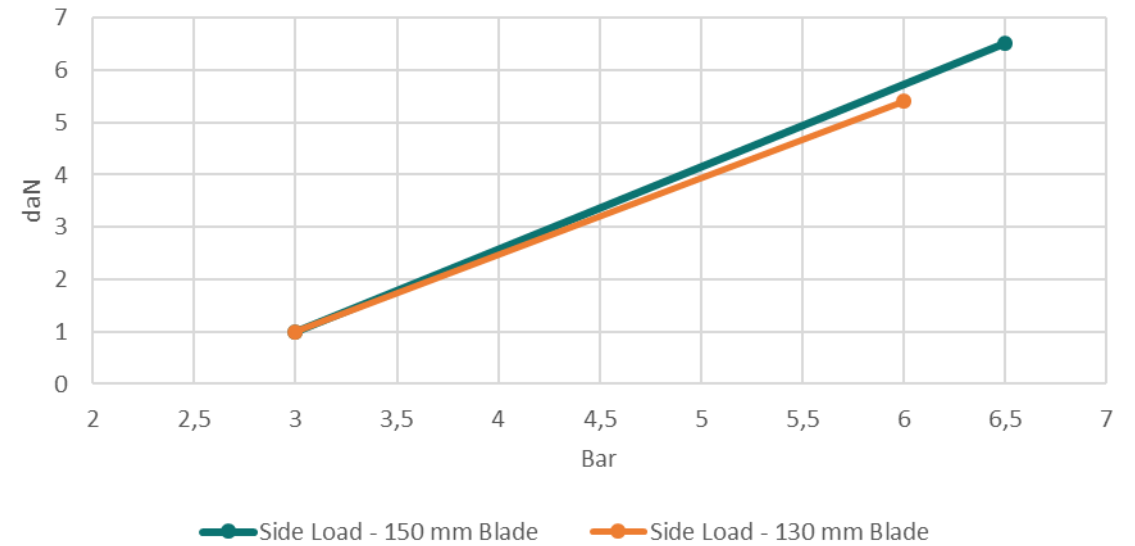

Side Load with **150mm** blade: 6,5 daN at 6,5 Bar pressure.
Side Load with **130mm** blade: 5,4 daN at 6 Bar pressure.



Video Link:



<https://youtu.be/eMxM077viWQ>

For further information:

Mario Cotta – Zincometal S.p.A.

C.so Europa 87, 20010 Inveruno (MI)

Tel. +39 02 979 661

Email: sales@mariocotta.com

www.mariocotta.com